

RHF7050A

The RHF7050A employs patented analogue temperature compensation to deliver tight stability down to ± 0.28 ppm for high frequency differential outputs up to 1 GHz (or CMOS outputs up to 180 MHz) in a small 7.0 x 5.0 mm hermetically sealed SMD package.

Features

- CMOS, LVPECL, or LVDS output options
- Custom frequency up to 1 GHz output
- Frequency slope and perturbation specifications can be customized
- VCO tilt compensation

Applications

- Networking
- Base Stations
- Communications
- DSL/ADSL
- IP Timing

7.0 x 5.0 x 1.65 mm

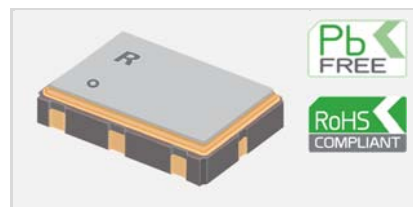

Standard Specifications

Parameter	Min.	Typ.	Max.	Unit	Test Condition / Description
Nominal frequency		25 – 1000		MHz	CMOS output frequency up to 180MHz
Frequency calibration			± 1	ppm	Initial accuracy at $25 \pm 1^\circ\text{C}$
Reflow shift			± 1	ppm	Pre to post reflow ΔF (measured ≥ 60 minutes after reflow)
Operating temperature range	-40		85	$^\circ\text{C}$	
Frequency stability over temperature			$\pm 0.28 - \pm 2.5$	ppm	Reference to $(F_{\text{max}} + F_{\text{min}})/2$. The best available stability depends on the nominal frequency and selected operating temperature range
Frequency slope			0.1	ppm/ $^\circ\text{C}$	Minimum of 1 frequency reading every 2°C , over the operating temperature range
Supply voltage stability			± 0.1	ppm	•
Load sensitivity			± 10	ppb	• HCMOS, ACMOS: $\pm 5\text{pF}$ variation, • Clipped sine wave / Sine wave: $\pm 10\%$ variation reference to frequency at nominal load
Long term stability (ageing)			± 1 ± 2 ± 6	ppm ppm ppm	Per 1 year Per 2 year Per 10 year
Supply voltage, V_{CC}		3.3		V	$\pm 5\%$
Current (CMOS)			35	mA	25 – 180MHz
Current (LVPECL)			50	mA	25MHz – 1GHz
Current (LVDS)			40	mA	25MHz – 1GHz
Control voltage, V_{c}		1.65		V	
Frequency tuning	± 3			ppm	Nominal control voltage $\pm 1\text{V}$
VCO pin input impedance			100	k Ω	
Frequency tuning linearity			10	%	Deviation from straight line curve fit
Oscillator output (CMOS)					
V_{OL}			$10\%V_{\text{DD}}$	V	15pF capacity load
V_{OH}	$90\%V_{\text{DD}}$			V	15pF capacity load
Duty cycle	48		52	%	Measured at 50% V_{DD} trigger level
Oscillator output (LVPECL)					
V_{OL}			$V_{\text{DD}} - 1.6$	V	50 Ω nominal load
V_{OH}	$V_{\text{DD}} - 1.03$			V	50 Ω nominal load
Duty cycle					Measured at $V_{\text{DD}} - 2\text{V}$
Oscillator output (LVDS)					
Duty cycle	48	350	52	mV	Measured at 1.25V

SSB Phase Noise (Typical value at 25°C)

100.000 MHz RHF7050 TCXO SSB Phase Noise

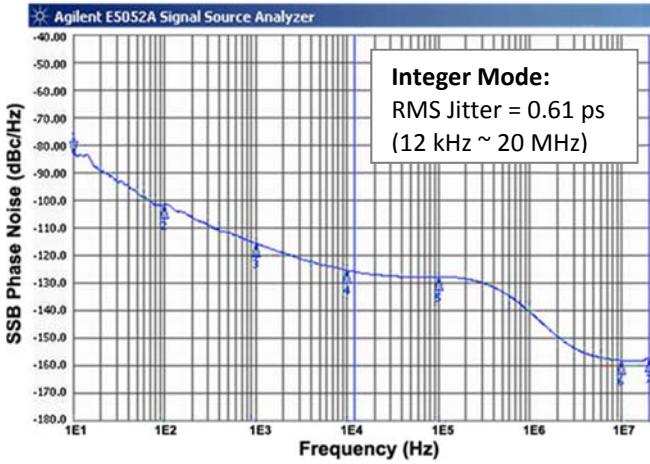

133.333 MHz RHF7050 TCXO SSB Phase Noise

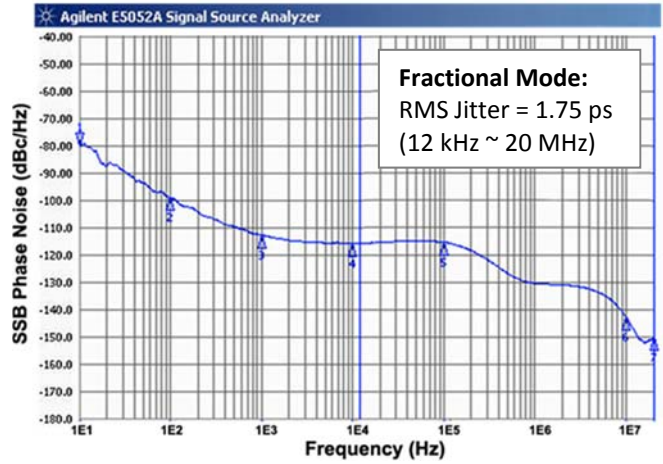

The standard frequencies as the multiples of 25 (25, 50, 100, 125, etc.)

Please send an email to Sales@rakon.com for availability of other frequencies.

Model Outline and Recommended Pad Layout

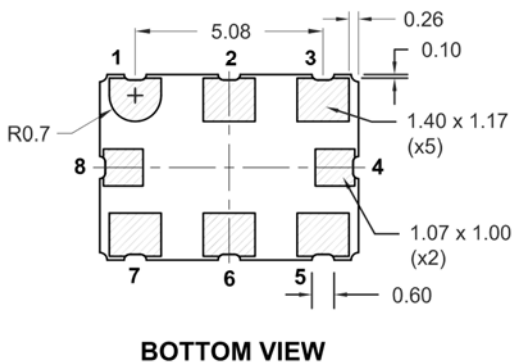
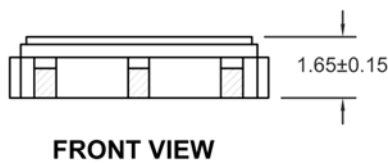
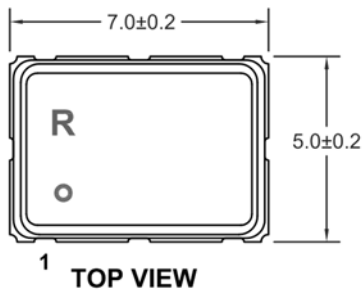

RECOMMENDED PAD LAYOUT - TOP VIEW

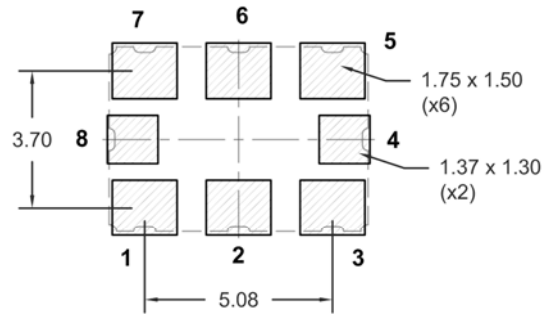

PIN CONNECTIONS

1*	V _C , NC
2*	E/D
3	GND
4	NC
5	Output
6*	Complementary Output (LVPECL/LVDS), NC
7	V _{DD}
8	NC

* Depending on the specifications

NOTE: Outline unit is mm.